

Handrail Profiles

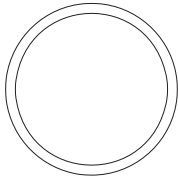

1.9" Pipe Schedule 10

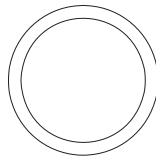

1.6" Pipe Schedule 40

Handrail Parts

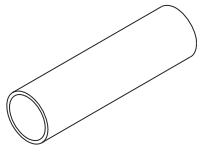

1.9" Inside Sleeve

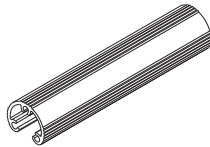

1.6" Inside Sleeve

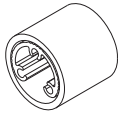

1.9" Inside Wall Mount
No Wall Plate

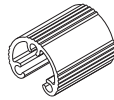

1.6" Inside Wall Mount
No Wall Plate

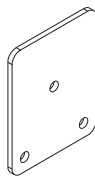

Wall Plate for
1.9" or 1.6" Inside Wall



1.9" or 1.6" Pipe
Extruded Side Mount

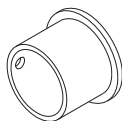

1.9" Cap

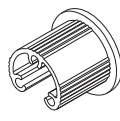

1.6" Cap

Handrail Elbows

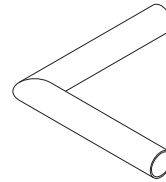

1.9" or 1.6" Pipe
Mitered 90° 12"x12"

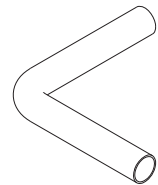

1.9" or 1.6" Pipe
Bent 90° 12"x12"

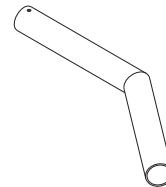

1.9" or 1.6" Pipe
Mitered 143° 12"x12"
(for 37° Stairs)

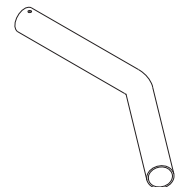

1.9" or 1.6" Pipe
Bent 143° 12"x12"
(for 37° Stairs)

Fabricated to Order Samples

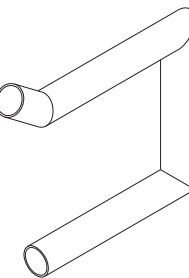

1.9" or 1.6"
Mitered Bullnose

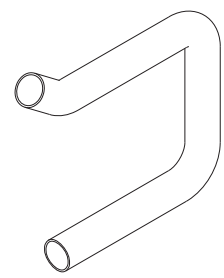

1.9" or 1.6"
Bent Bullnose



1.9" or 1.6" Pipe
Extruded Side Mount
3" Centerline
(Cross Cut at Stair Angle)

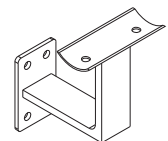

Custom Offset
Side Mount for
1.9" or 1.6"

**TEMPLATE FORMS MAY BE AVAILABLE
TO BE FILLED FOR THESE ITEMS.**